



CROSSPOINT
CHURCH

Carrying On The Vision

Investing in the next generation
to be equipped for ministry



Carrying On The Vision

 뉴 비기닝 크로스포인트

 焦点基督教会

 **CROSSPOINT**
CHURCH

 Three congregations
One church



Our mission is to equip and send passionate followers of Jesus to renew our community and world for Christ.

54 years of God's faithfulness

CALVARY CHRISTIAN REFORMED CHURCH

1969  2023

CROSSPOINT CHURCH



54 years of God's faithfulness

CALVARY CHRISTIAN REFORMED CHURCH

1969  2023

CROSSPOINT CHURCH



A growing community



CITY OF CHINO 6th Cycle Housing Element Update (2021-2029)



Table 2-1: Population Growth (2010-2040)

Jurisdictions	Population					Percent Change	
	2010 Actual	2012 Projected	2020 Projected	2035 Projected	2040 Projected	2010-2020	2020-2040
Chino Hills	74,799	75,800	76,500	89,000	94,900	2.3%	24.1%
Chino	77,983	79,400	86,200	114,200	120,400	10.5%	39.7%
Rancho Cucamonga	165,269	170,100	173,900	198,300	204,300	5.2%	17.5%
Ontario	163,924	166,300	197,600	248,800	258,600	20.5%	30.9%
San Bernardino County	1,995,156	2,068,000	2,197,400	2,637,400	2,731,300	10.1%	-5.9%



Represents an estimate from the SCAG 2016-2040 Regional Growth Forecast.

Sources: Bureau of the Census (2010) and SCAG 2016-2040 Regional Growth Forecast by Jurisdiction Report.

A growing church

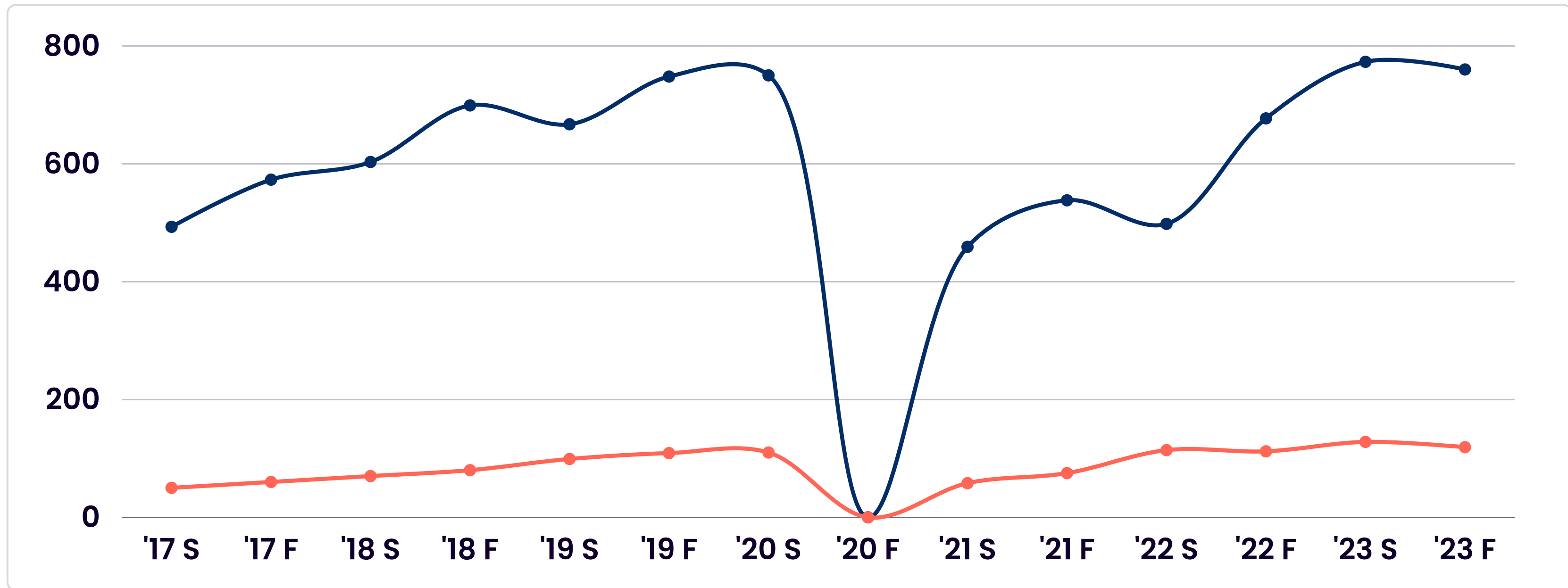

CPkids + littles
current Sunday avg = 119

CP 3 Congregations
current Sunday avg = 760

A growing need

- Current building completed in 2005
- Land with plenty of room to grow
- Phase 2 for more classroom space was part of the plan from the beginning

Is now the time to invest in the next generation of ministry?

Thank you for being here to prayerfully consider that with us today!



Children and Youth Ministries

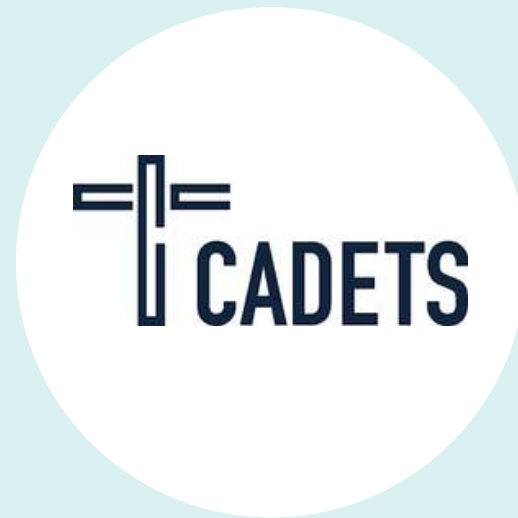
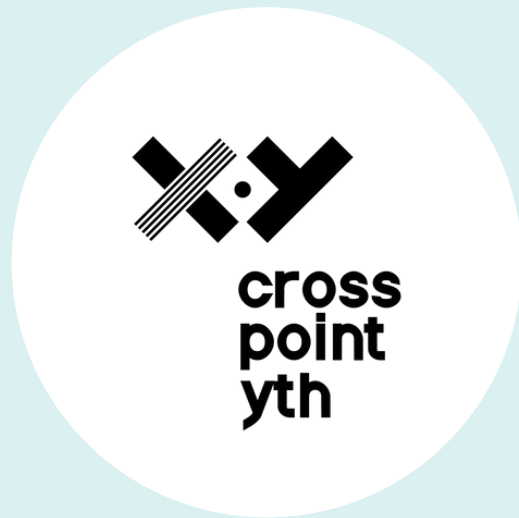

Sunday Morning CPkids and CPLittles

CPkids

CP
littles

- CPkids begins with large group worship and teaching and then moves to classrooms by age group
- CPkids (K-6th) regularly has 115 kids and leaders
- CPLittles (0-5 years) regularly has 50 kids and leaders



Sunday Morning Space Concerns

CPkids

CP
littles

- Pushing the limits on code requirements
- Classrooms with up to 30 kids
- Safety and security
 - 5 exit doors
 - No child-sized restrooms
- May give guest families the first impression of not enough room for us here
- Age-appropriate discipleship
- Child-friendly environment



Wednesday Night GEMS, Cadets, CP Youth

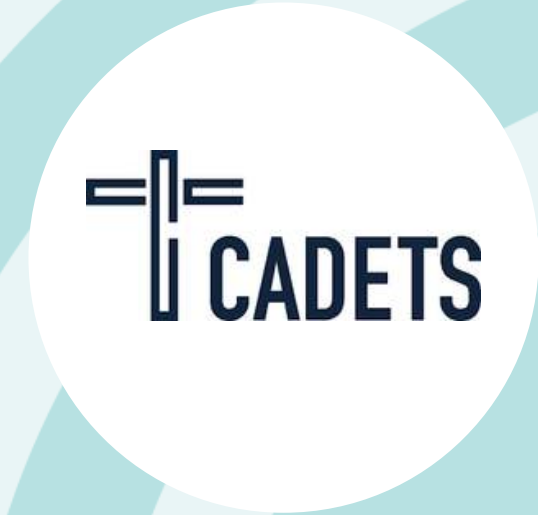

- GEMS has 115 girls and 29 leaders and is the largest club globally
- Cadets has 100 boys and 34 leaders and is the largest club in North America
- CP Youth serves 50-60 students weekly



Wednesday Night Concerns



- GEMS registration is capped due to space constraints with a waitlist of 5 girls
- Cadets begin in the Music Room, it is standing room only
- Small groups meet in every space including nursery and staff offices
- We are missing family discipleship opportunities; no spaces are available for classes or small groups





Exploring The Alternatives

Why don't we...



CROSSPOINT
children's center

A Faith-based Preschool



Why don't we...

Use the CrossPoint Preschool building

- Student pick up ends at 6:30 PM
- Classroom furniture size
- Set up and take down for school the next day
- Rigorous cleaning necessary due to licensing requirements



Why don't we...

Have two worship services

- We are not near worship center capacity (1500)
- Twice as many volunteers are needed
- Would not help with space issues after the service
- Would not help with Wednesday night space issues

Why don't we...

Use other classrooms on Sunday mornings

- Would not help with Wednesday nights
- Most rooms utilized on Sunday mornings
- Kids check-in happens all morning
- A large and busy church campus makes it difficult to ensure security for children



Why don't we...

Not have kids from other churches in our GEMS and Cadets

- Not all churches are equipped to have these programs for children and families
- We desire to reach all families in our community
- GEMS church statistics:
 - 9% no church
 - 42% CrossPoint
 - 49% other churches
- Cadet statistics:
 - 2% no church
 - 63% CrossPoint
 - 36% other churches

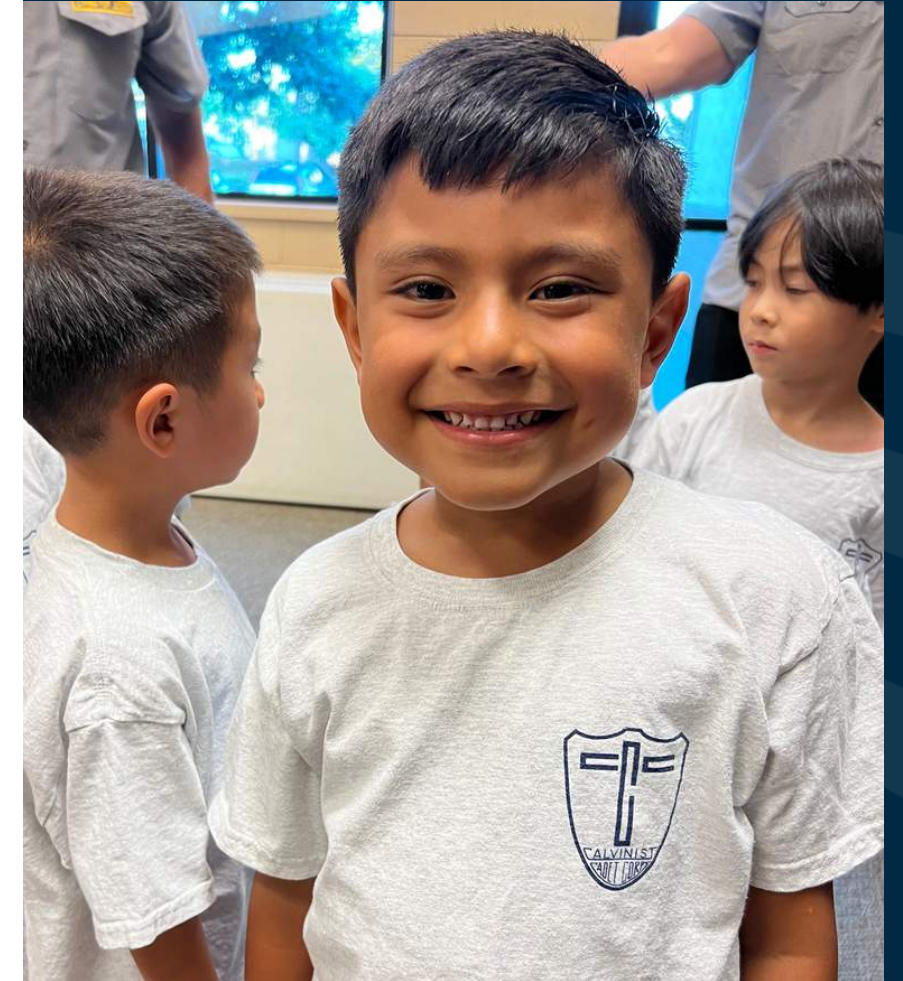



Why don't we...

Build portable classrooms

- Expensive option for a temporary solution
- Security and aesthetics

Have multiple nights for kids programs

- Does not help with Sunday mornings
- Creates hardships for some families, breaks up family time

Exploring Expansion





CrossPoint expansion plans... a short history

- 25 acres and Phase 1 construction completed in December 2005 with our current buildings
- Intention to move to Phase 2 for more classrooms when necessary
- CP Land Development Committee performed a comprehensive Needs Assessment and finished early 2019



CrossPoint expansion plans... a short history

- Assessment Results
 - More classroom and nursery space needed
 - Space needed for Wednesday evenings and Sunday mornings
- Additional space would provide opportunities for all three congregations to meet at the same time if desired





CrossPoint expansion plans... a short history

A large building was schematically designed, which was 38,000 square feet. It included classrooms, a café, two large group meeting rooms, and a dedicated worship space for the Chinese congregation.



CrossPoint expansion plans... a short history

- Covid derailed the effort towards the 2020 building and plans were put on hold
- The needs of 5 years ago have come to fruition; we are growing and see the need to create sufficient space to accommodate our ministries

A Proposed Solution

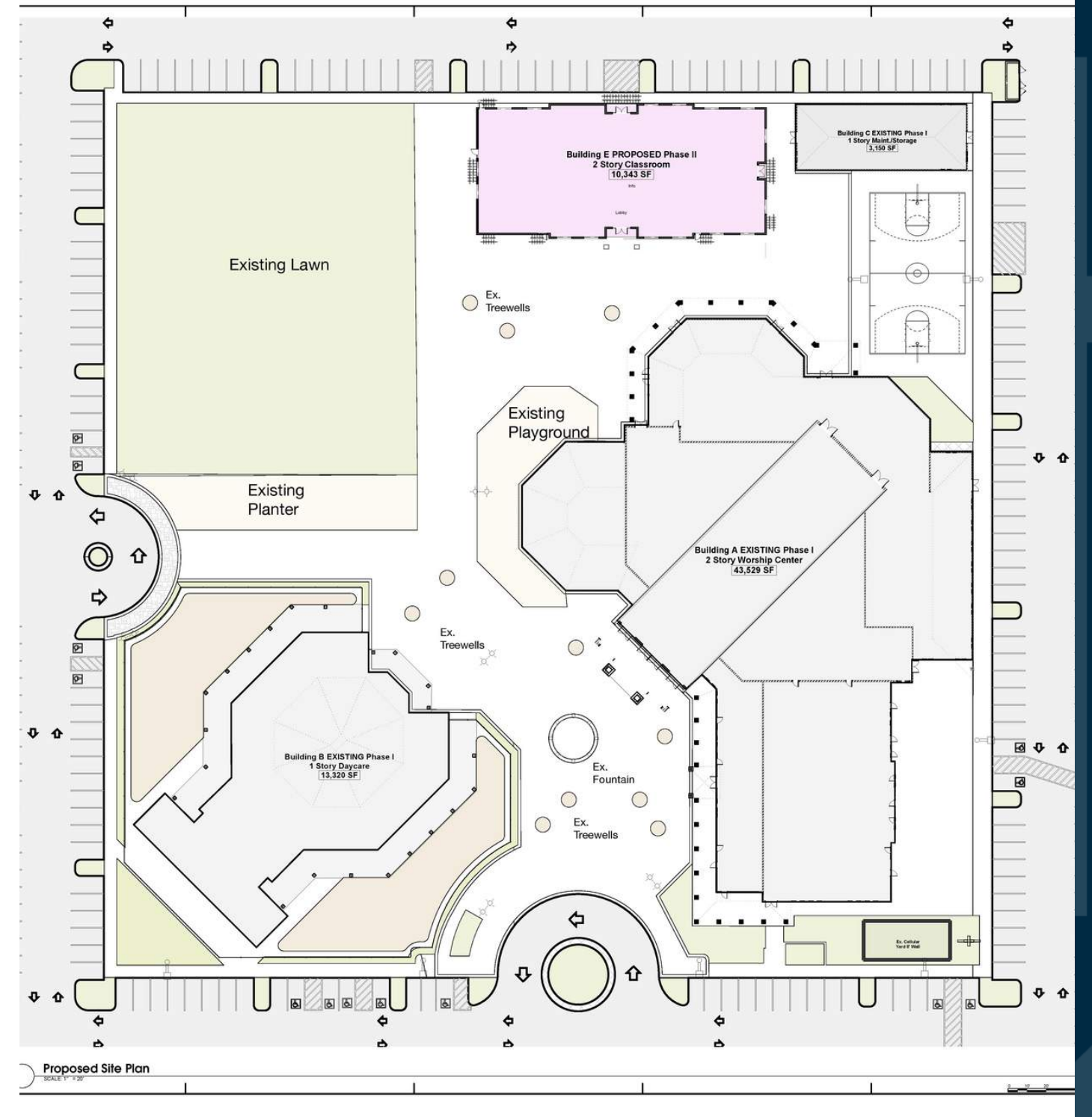

A Proposed Solution

CrossPoint Ministry Building



CP Ministry Building

- The original city-approved Conditional Use Permit includes Phase 2, a 20,000 sq ft 2-story ministry building
- This building would meet the needs for classrooms and additional nursery space
- Preliminary design conforms to drawings approved with the original CUP, which allows for quicker city approvals

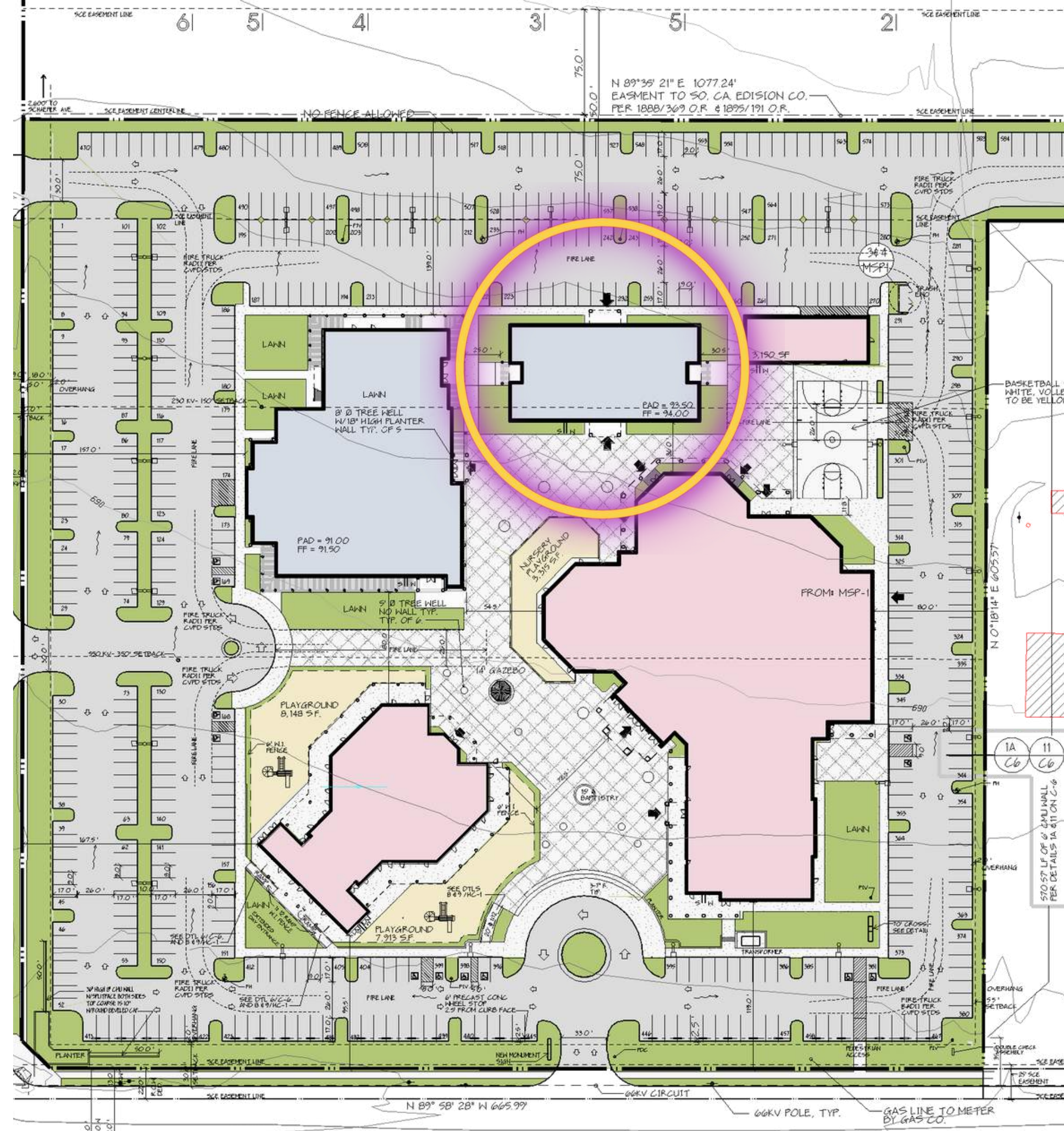

North Elevation
SCALE: 3/16" = 1'-0"



South Elevation
SCALE: 3/16" = 1'-0"

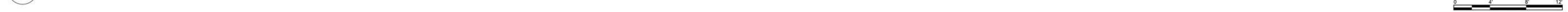

Building features:

- 26 classrooms of varying size
- Family room
- Nursery area
- 2 large group gathering spaces
- Storage and small kitchen
- Adult and child sized restroom facilities

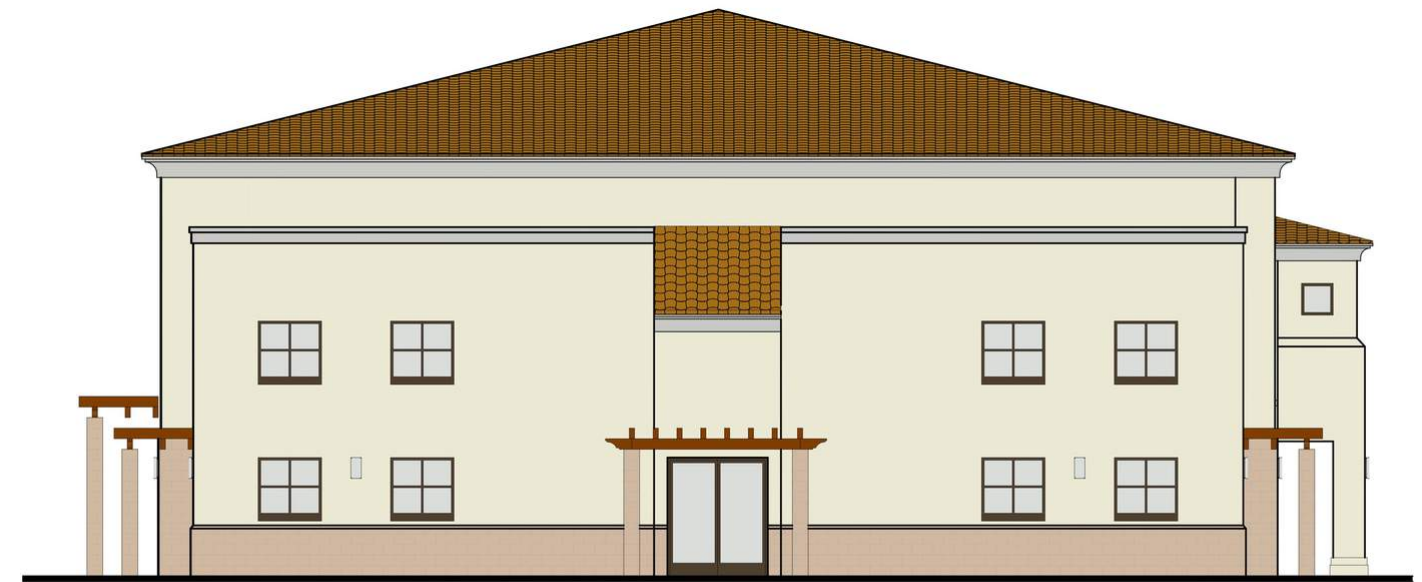

East Elevation
SCALE: 3/16" = 1'-0"

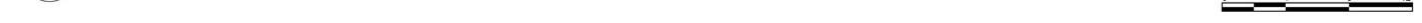

The Financial Picture



Building Cost Estimate

New building cost estimate
from our architect

\$250 - \$300
per sq ft

Estimate for 20,000 sq ft
2 floor structure

\$5,000,000-
\$6,000,000

Estimated furnishings and equipment

\$500,000

Total

\$6,500,000



Current Financials

Building Estimate	\$6,500,000
Current funds available in Building Fund allocated to new building	<u>(\$750,000)</u>
Balance needed for new building	\$5,750,000
Remaining current mortgage balance	\$1,000,000
Total debt (post construction)	\$6,750,000



Funding Building Construction

1. Pledge campaign raises \$6,750,000
 - Best option; raises funds for new building and pays off remaining mortgage balance
2. Pledge campaign total + loan for the remainder
 - Finance team would evaluate this option for General Budget handling the loan payment



Funding Building Construction

3. Pledge campaign total + sale of 2.9 acres along Euclid
 - Provides additional funds to reduce or eliminate impact to General Budget
 - Would require vote and approval of congregation





Power Line Easement

2.9 acres

Power Line Easement

Fern Avenue

Proposed Ministry Building site

Euclid Avenue

CROSSPOINT CHURCH

CROSSPOINT children's center

Edison Avenue

2.9 Acres on Euclid

- What portion of our property is this?
- What is it used for now?
- What is the benefit of using it for the Ministry Building?



What's Next



What are we voting on?

Although our bylaws state that motions can pass by member vote only, everyone's voice matters to us!

On November 5, by paper ballot, CP members will vote yes or no and CP attenders will vote support or no support on the following motion:



What are we voting on?

Motion:

To approve the processing of pledges, all financing, and the preparation of construction documents related to the new ministry building. And, when necessary funds are available, the commencement of construction.

Note: Absentee ballots will be available 1 week prior for those unable to attend on November 5

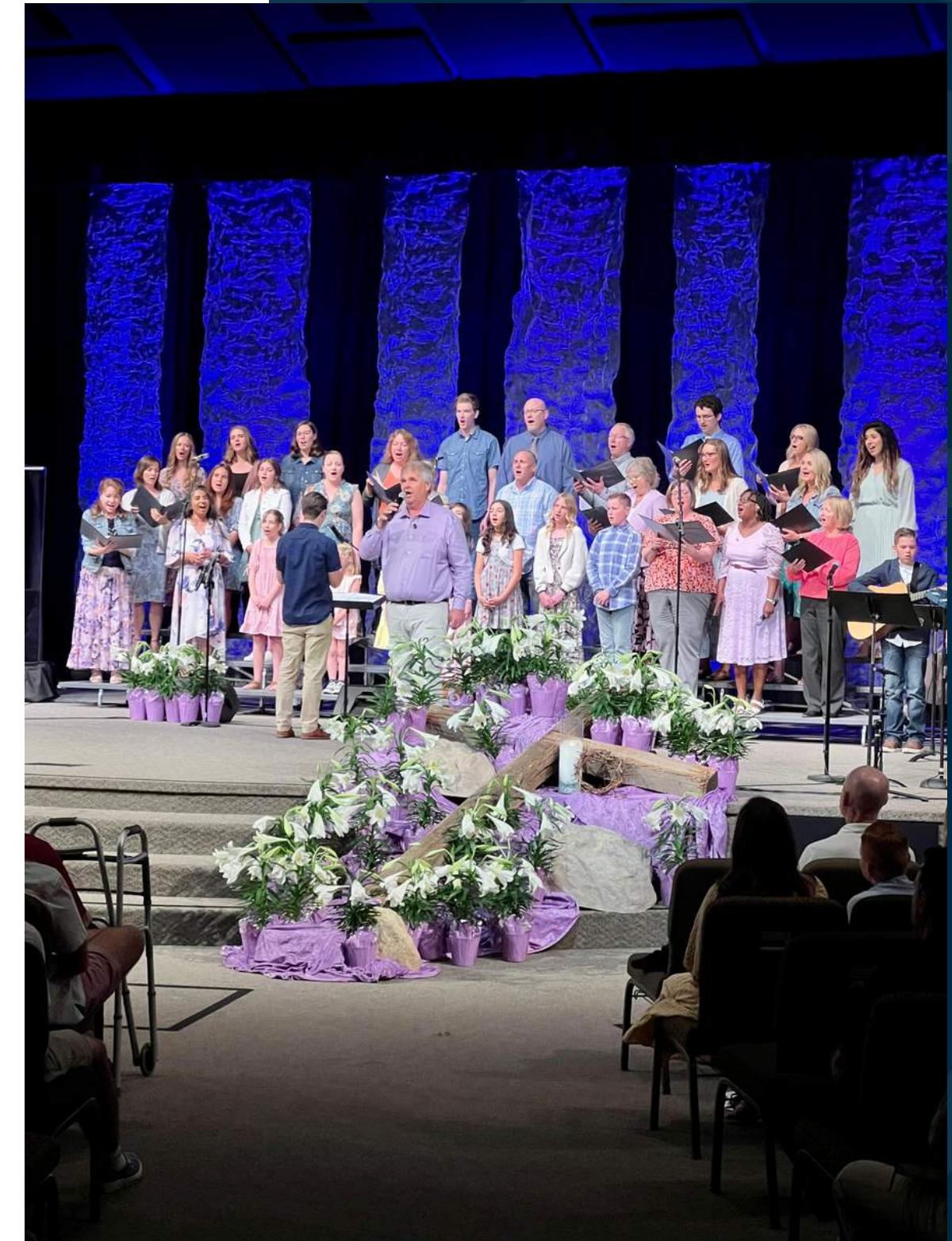

Pledge Campaign

Carrying On The Vision

Make a Pledge

November 12 - December 31

Fulfill your Pledge

November 2023 to December 2026

If you would like to kick off the campaign with an early gift, speak to a team member or give at crosspointchino.org/vision



Important Dates



October 15

11 AM | Worship Center

Same presentation as today if you would like to attend again

October 22

11 AM | Worship Center

Q & A Congregational session

October 29

11 AM | Conference Room

Individual Q & A with building committee

November 5

11 AM | Worship Center

Voting Sunday

November 12

Close of worship service

Voting results

Pledge Campaign Kick Off

Carrying On The Vision

crosspointchino.org/vision

- Submit questions
- Give a kick off gift or pledge
- See the presentation slides and handout
- Watch the video
- Request membership status

